

## Skyhawk CE-Skyhawk Trapmate Release Notes

Version: 6.2.0 (Build ID: 9604169)

The latest production release of the Skyhawk CE-Skyhawk Trapmate mobile application brings with it new features and enhancements to the deployment and pickup process, along with a variety of general improvements and fixes. These release notes will specifically highlight the updates to the deployment and pickup process.

### Simplified Deployment Workflow

Device deployment has been simplified to minimize the need for entering data related to deployments. The new workflow also includes the ability to make “bulk” deployments, deploying several devices in one action. The new flow works as follows:

- Initiate the deployment process by clicking on the **Deploy** tab
- Select the customer and location
- Select the device(s) you need to deploy. You can do this by searching for the device serial number or the device name, by using the **Scan** button to scan the device QR code, or by tapping the radio buttons next to the device(s) in the list.

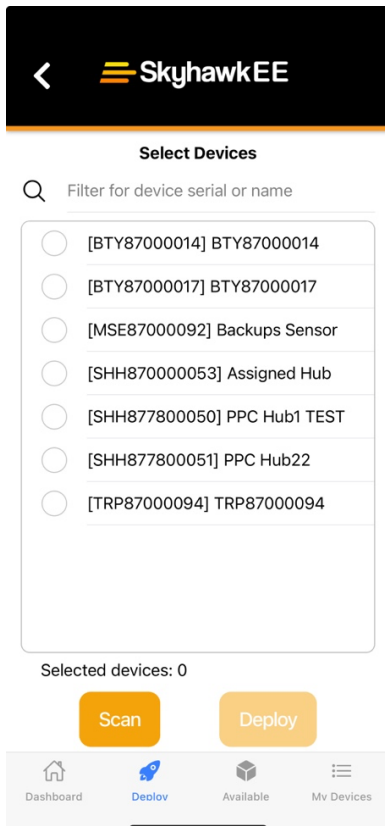

- Click the **Deploy** button

Your devices are now deployed.

## Updating Device Deployment Details

Updating deployment details is now done by updating the device details. First, find the device you want to update. You can then set the GPS location for the deployed device using the **Location** tab under the device view. You can also update the device name and deployment description using the **Settings** tab.

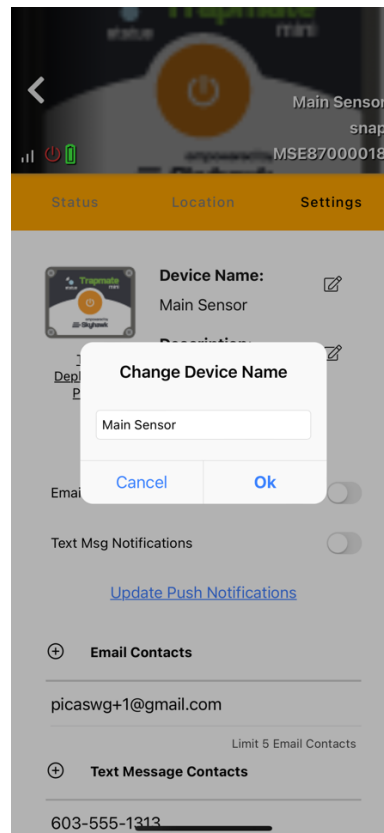
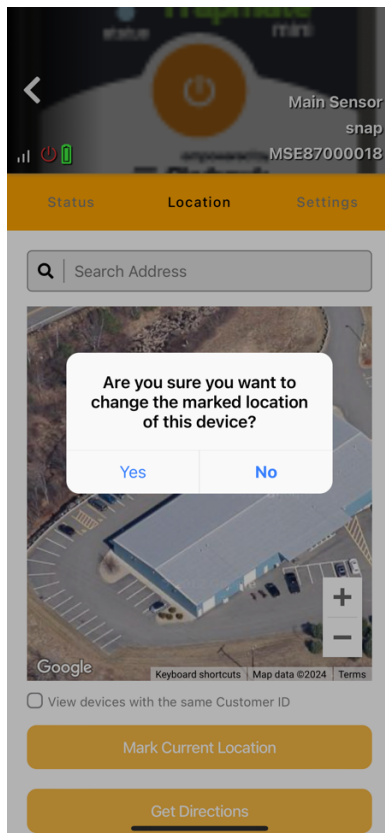

## QR Code Scan for Quick Device Finding

To provide an option for quickly accessing individual devices, we've added a new QR Code Scanner floating action button to the Deployment dashboard, as well as any device list view. To utilize this, click on the QR Code Scanner floating action button, and then scan the QR code for the device you want to access. Doing this automatically brings you to the device view for the device in question.

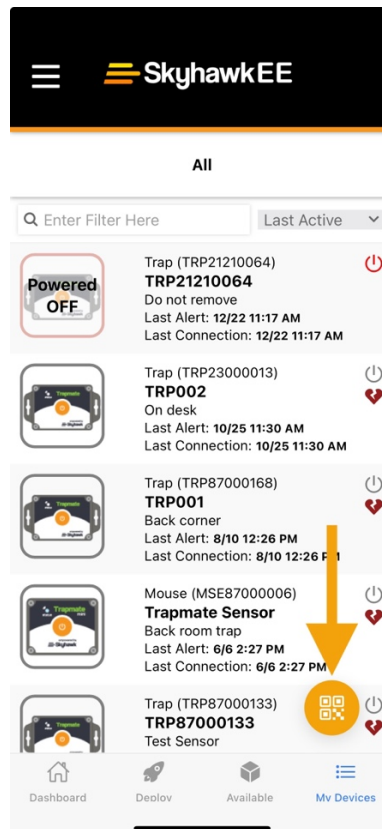

## Device Checking and Pickup Enhancements

Enhancements were made to simplify the device checking and pickup process.

- A **Capture** checkbox has been added. You can now click on this checkbox to confirm that there was a capture for the current deployment. No additional information is required to complete your check. This checkbox will further improve heatmap data via the Enterprise Portal.
- Once you've completed your check, click on the **Trap Checked** button. This automatically creates a new deployment record with the exact same details as it previously had for the given device.
- When it is time to pull devices out of a deployment, simply click on the **Remove Unit** button.